

WYKAMOL CORNERTAPE

Corner Tape is an extruded butyl tape with a permanent polyethylene film backing, designed for taping over joints in membranes.



Wykamol Corner Tape is a 150 mm wide tape with many uses, but most commonly used to seal membranes from walls to floors and fixing perimeter drainage channels in place.

Tacky on one side only, this can also be used to overtape external joints and can also be used on floor oversealing and is covered by our **BBA Certificate**.

Surface preparation: All surfaces should be clean, dry and free from frost, grease and loose materials. **Application:** Remove the backing paper and press the exposed butyl onto the membrane. Press firmly into place, the use of a roller to roll the joint, using firm pressure, is recommended to get a good bond.

ADVANTAGES

- Good adhesion to a wide range of substrates once primed with Technoseal.
- Easy and accurate to use with little waste and no mess.
- The softer composition makes this product highly conformable.
- Remains flexible throughout its service life.
- High tack.
- Provides a waterproof seal when correctly installed.
- Can be used to fix many membrane and perimeter drainage channel applications.
- Works in conjunction with Wykamol Cavity Drain Membrane Systems.

TYPICAL USES

For taping over joints in membranes used in building and construction, for example damp proof membranes, cavity drain membranes and vapour control layers, as an additional seal to Membrane Tape or High Performance Membrane Tape.

PACK SIZE AND COVERAGE

Pack Size	Product Code
1 Roll 150 mm x 20 mm	WYKCSTRIP20

STORAGE & SHELF LIFE

Keep tape rolled up when not in use. Keep away from damp or heat and store in box provided. Shelf life is 24 months when stored flat in original packaging in cool, dry conditions.

HEALTH AND SAFETY

For further information and advice, please contact the Wykamol Technical Department and consult the safety data sheet, which is available upon request or can be downloaded from our website.



PERFORMANCE	UNIT	NOMINAL VALUE	TEST METHOD
T-Peel Adhesion to 250 micron PE membrane	N/cm	12	H45
Specific Gravity	g/cm ³	1.6	DIN EN ISO 10563
Moisture Vapour Transmission Rate	g/m ² /24hr/mm	0.16	ISO9932 / BS ISO 15106
Service Temperature Range	°C	-40 to +90	-

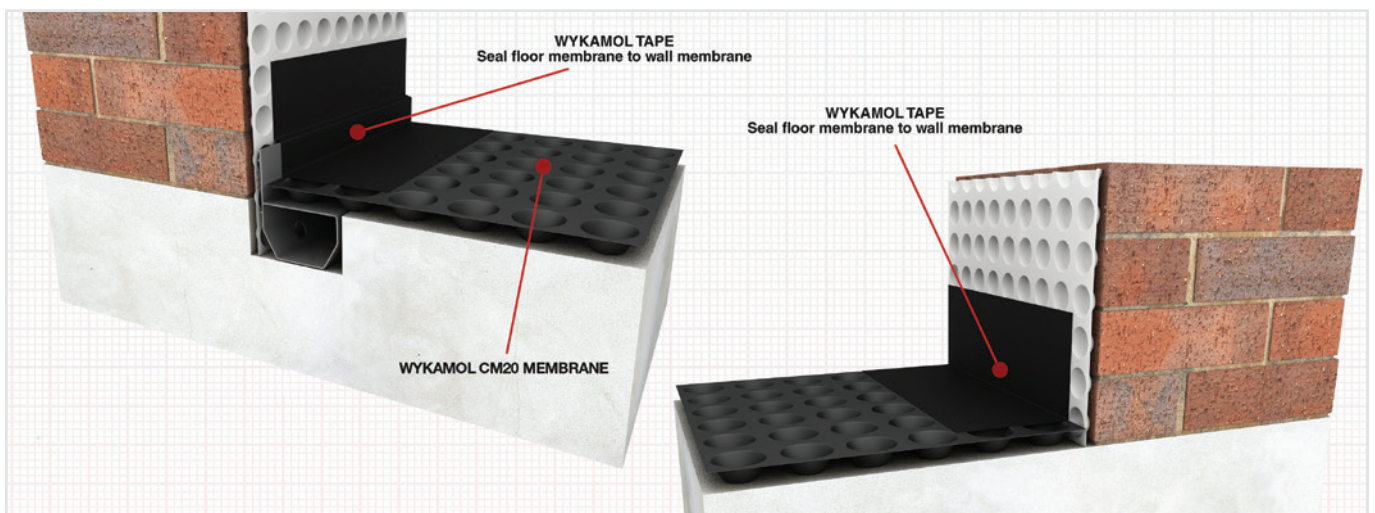

Unit 3, Boran Court, Network 65 Business Park, Hapton, Burnley
Lancashire BB11 5TH

t: +44 (0)845 4006666 f: +44 (0)845 4003333

www.wykamol.com e: info@wykamol.com



The information in this technical datasheet is given in good faith and was correct at the time of publication, but does not purport to be all inclusive. We reserve the right to update this information at any time without prior notice. All data is obtained through extensive testing in stringent laboratory conditions, however as we have no control over site conditions or work executed we accept no liability for incidental and/or consequential property damage arising out of the use of this product. The Wykamol Group's standard terms and conditions of sale apply.