



## CD-552 - Ancillary products

### KEY FEATURES

- Manufactured from durable ductile iron
- Loop handle design for ease of use
- Standard and 'Long' versions available
- Head sizes in accordance with BS 5834-2:2011 keyway dimensions
- suitable for use with C250, D400, E600 & F900 products
- Supplied in pairs



## CD-552 - Specifications

Overall length	160
Head size	Large
Material	Spheroid Graphite Iron Grade EN-GJS-500-7 to BS EN 1563:2011 Temporary Bitumen based paint coating to BS 3416:1991

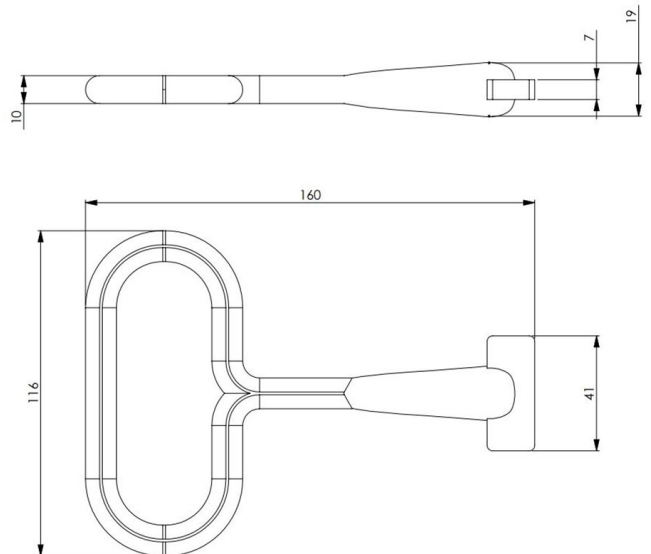

CD552/V0.1/31-05-2023

Due to our continuous product improvement program features and sizes may be subject to change without notice.

**CLARK DRAIN, STATION ROAD, YAXLEY, PETERBOROUGH, PE7 3EQ, TEL. +44 (0) 1733 765317**