



JETFLOW SJMF

ELTA >>>
TRADE

JETFLOW SJMF

EC In-line Mixed Flow Circular Fan

Compact EC in-line mixed flow fan, designed specifically for use with rigid or flexible ductwork. Perfect for residential, industrial and commercial installations.

IMPROVES INDOOR AIR QUALITY

Better health and reduced heating costs.



Available in 7 sizes from 100mm - 355mm.



High performance and energy efficient brushless EC motor results in low SFP.



Integrated mounting foot simplifies installation.



Easy control with industry-standard 0-10v connection. Allows quick connection to sensors and run-on timers.

01384 275771
info@eltatrade.co.uk
www.eltatrade.co.uk

**WE COULDN'T FIT
EVERYTHING ON HERE,
SCAN THE QR CODE TO
FIND OUT MORE**



FEATURES & BENEFITS

- **EC brushless motor** means even at full speed, its performance is smooth, quiet and super efficient.
- **Double mixed flow impeller** produces strong pressure at any speed, allowing the fan to be slowed down and deliver the exact performance needed. This reduces heat loss through over-ventilation.
- **Detachable Bracket** on models 150 to 315mm for ease of installation.
- **Speed controllable** and can be paired with optional accessories and sensors for complete control.
- **Easy Installation;** fitted with a 1.5 metre mains lead complete with UK 3-pin plug. Convenient for connecting to electrical sockets and providing a means of isolation/disconnection.
- **Low power consumption** at high performance resulting in Low Specific Fan Powers for Building Regulation Compliance.
- **2 year warranty,** for full details, visit www.eltatrade.co.uk.

PERFORMANCE DATA

JETFLOW SJMF	100	125	150	200	250	315	355
Airflow L/s (m³/h) @ 100pa	48 (173)	68 (245)	130 (468)	253 (911)	427 (1538)	773 (2783)	1140 (4104)
Power W	21	27	49	100	172	375	538
Sound Pressure dB(A) @ 3m	47	48	51	52	56	62	66
Volts Hertz	220-240 50/60						
Max Ambient Temperature °C Degree of Protection	60 IPX4						

For full technical data, please refer to www.eltatrade.co.uk.

DIMENSIONS

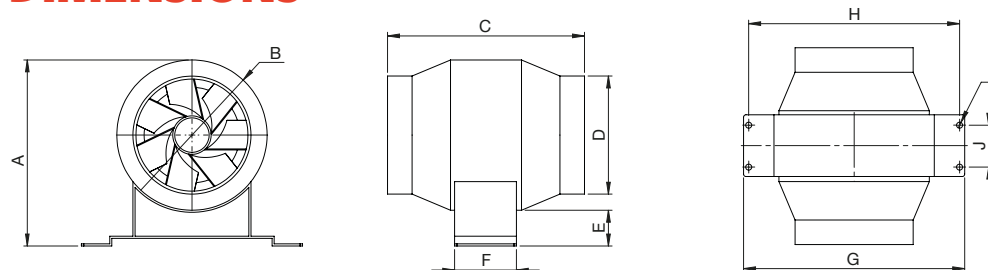

MODEL	A	ØB	C	ØD	E	F	G	H	J	K	Weight kg
SJMF 100	150	125	159	98	25	51	184	175	37	5	1.1
SJMF 125	151	126	110	124	26	51	184	175	37	5	1.1
SJMF 150	173	153	165	150	21	80	187	175	37	5 x 8 SLOT	1.6
SJMF 200	223	203	220	200	22	105	221	210	39	5 x 8 SLOT	2.6
SJMF 250	274	254	210	250	22	105	300	288	26	5 x 8 SLOT	3.7
SJMF 315	356	317	290	313	39	164	360	336	68	9 x 14 SLOT	8.5
SJMF 355	401	358	330	353	45	184	405	380	77	9 x 14 SLOT	12.0

Dimensions in mm.